



 paulwallace

Cadmore Lane, Cheshunt, EN8 9JG |  
Offers in the Region Of £300,000 | Freehold

Cadmore Lane, Cheshunt, EN8 9JG

\*\* CHAIN FREE \*\* TWO DOUBLE BEDROOMS and two reception rooms.  
END OF TERRACE property IN NEED OF MODERNISATION with ground  
floor bathroom, LARGE REAR GARDEN .

### Key features

- \*\* CHAIN FREE \*\*
- Two Double Bedrooms
- Two Reception Rooms
- End Of Terrace
- In Need Of Modernisation
- Ground Floor Bathroom
- Large Rear Garden
- Close To The Station

### Property Information

Tenure  
Freehold

Council Tax  
C

EPC Rating  
G

Local Authority

Lease Length

Service Charge & Ground Rent  
TBC



 paulwallace  
estate agents

hoddlesdon@paulwallace.co.uk

01992 466471



 paulwallace



GROUND FLOOR  
425 sq.ft. (39.5 sq.m.) approx.

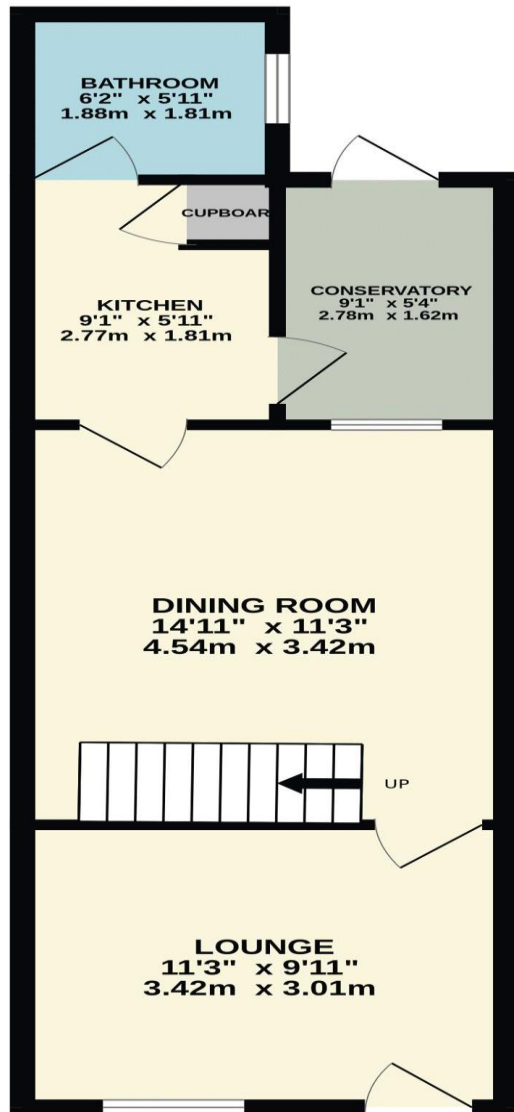

1ST FLOOR  
286 sq.ft. (26.6 sq.m.) approx.

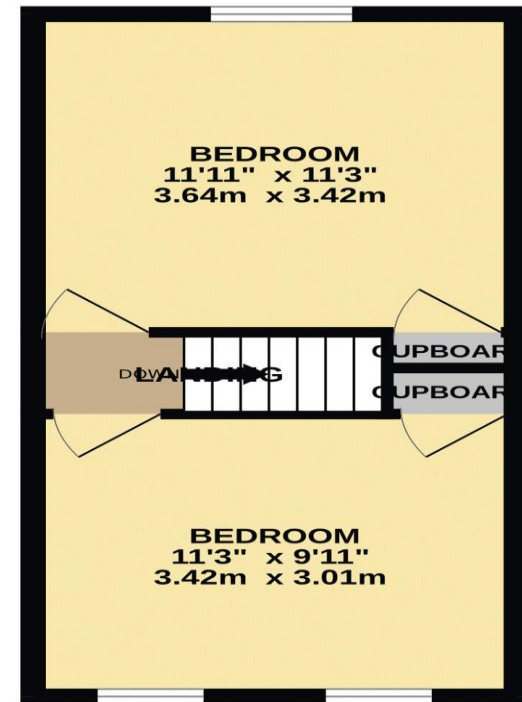

TOTAL FLOOR AREA : 711 sq.ft. (66.1 sq.m.) approx.

Whilst every attempt has been made to ensure the accuracy of the floorplan contained here, measurements of doors, windows, rooms and any other items are approximate and no responsibility is taken for any error, omission or mis-statement. This plan is for illustrative purposes only and should be used as such by any prospective purchaser. The services, systems and appliances shown have not been tested and no guarantee as to their operability or efficiency can be given.  
Made with Metropix ©2023





Registered Address: Unit 3 The Brookfield Centre, Cheshunt, Herts, EN8 0NN Company Registration Number: OC414280 | VAT Number: 276958046©2022 Paul Wallace Group LLP trading as Paul Wallace Estate Agents



**Paul Wallace Estate Agents**  
Brookfield Centre  
Cheshunt  
Hertfordshire  
EN8 0NN



01992 781100



cheshunt@paulwallace.co.uk



www.paulwallace.co.uk



Opening Times

Mon - Fri	9 am to 7 pm
Sat	9 am to 5:30 pm
Sun	Closed
Bank Hols	Closed



Agents note: Whilst every care has been taken to prepare these sales particulars, they are for guidance purposes only. All measurements are approximate and are for general guidance purposes only and whilst every care has been taken to ensure their accuracy, they should not be relied upon. Potential buyers are advised to recheck measurements.